



# VALVE ACTUATORS

## Pilot Actuators



Single Acting Spring Return Pilot Actuator

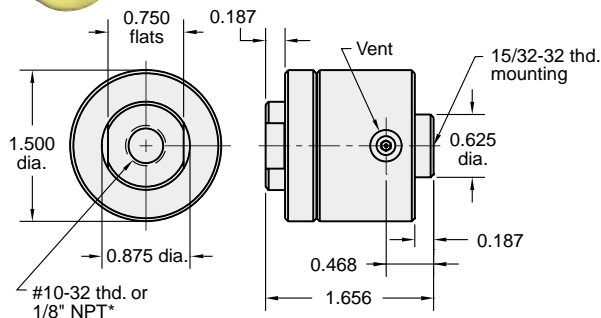

Bore Size: 1.250" dia.

Input Pressure: 150 psig max.

**Mounting:** 15/32-32 female thread to mount to Clippard Minimatic® valves and components; no spacers or washers are required when assembled to any Clippard valve; may be used with 15018-2 mounting bracket

Force Factor: 1.2

### Part No. Description

MPA-10 . . . Single Acting, Spring Return Actuator, #10-32  
MPA-10P . . . Single Acting, Spring Return Actuator, 1/8" NPT

## Vacuum Actuators



Single Acting Spring Return Vacuum Actuator

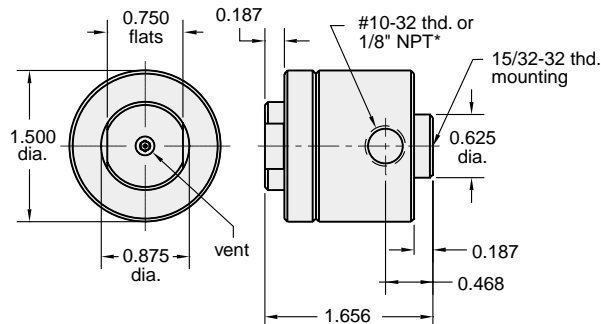

Input Pressure: 30 in. Hg vacuum

**Mounting:** 15/32-32 female thread to mount to Clippard Minimatic® valves and components; no spacers or washers are required when assembled to any Clippard valve; may be used with 15018-2 mounting bracket

### Part No. Description

MVA-10 . . . Single Acting, Spring Vacuum Actuator, #10-32  
MVA-10P . . . Single Acting, Spring Vacuum Actuator, 1/8" NPT

## Push Button Actuators, 5/8"

Round Solid Brass 5/8" dia. Push Button

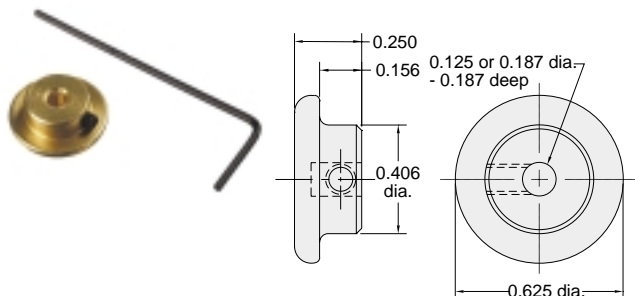

**Use:** Mounts directly on valve stem for manual operation of valve; prevents overtravel of valve stem by providing a positive stop

**Mounting:** 1/8" or 3/16" dia. mounting hole fits valve stems; locks in place by set screw (Allen wrench furnished)

**Note:** Individually packaged or bulk quantities available

### Part No. Description

11916-1 . . . 5/8" Brass Push Button, 1/8" Stem  
11916-2 . . . 5/8" Brass Push Button, 3/16" Stem

## Push Button Actuators, 13/32"

Round Solid Brass 13/32" dia. Push Button

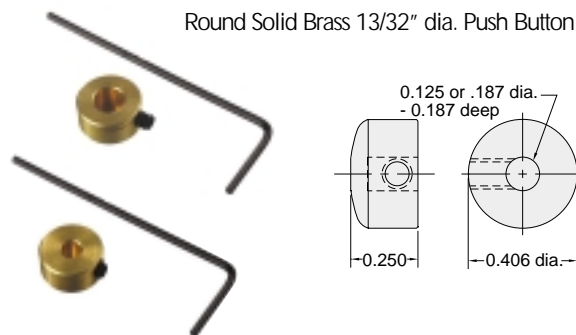

**Use:** Mounts directly on valve stem for manual operation of valve; small size permits attachment to valve before valve is mounted through 15/32" dia. hole; prevents overtravel of valve stem by providing a positive stop

**Mounting:** 1/8" or 3/16" dia. mounting hole fits valve stems; locks in place by set screw (Allen wrench furnished)

**Note:** Individually packaged or bulk quantities available

### Part No. Description

11916-3 . . . 13/32" Brass Push Button, 1/8" Stem  
11916-4 . . . 13/32" Brass Push Button, 3/16" Stem